



# MINI-COMPACT LED LANTERN

# MCL 140



The MCL 140 is a mini LED marine lantern, solar self-contained, which utilises one only high-power LED, giving a luminous range up to 5 nautical miles. It is characterized by its excellent optical system performance, minimising consumption and offering a big autonomy.

Ideal for short-range beaconing applications, on- and off-shore, requiring a low consumption, such as jetties, piers, buoys, fish farms, etc.

The battery is replaceable, thus the complete lantern disposal is not necessary at the end of battery's life. Standard fixings allow for a quick beacon replacement.

Designed according to IALA Recommendations.

## FEATURES

- ✓ High-efficiency luminous system .  
Up to 4 nm (T=0.74), 5 nm (T=0.85).
- ✓ Vertical divergence up to 15°.
- ✓ 360° horizontal output.
- ✓ Average operation lifetime over 10 years.
- ✓ All components can be easily replaced.
- ✓ IP 68 watertightness degree (immersion resistant).
- ✓ High shock resistance.
- ✓ Anti-humidity device in order to avoid condensation.
- ✓ Autonomy without solar charging up to 300 hours.
- ✓ Automatic energy management, according to latitude.
- ✓ Programming, configuration and operating status via PC, IR programmer or Bluetooth as an option.
- ✓ Optional GPS synchronization.



# MINI-COMPACT LED LANTERN

## MCL 140



Specifications subject to change without previous notice. Luminous ranges will be affected depending on latitude, flash rhythms and chosen options.

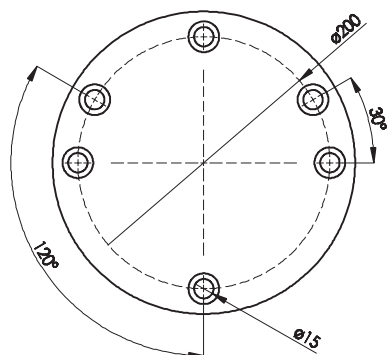
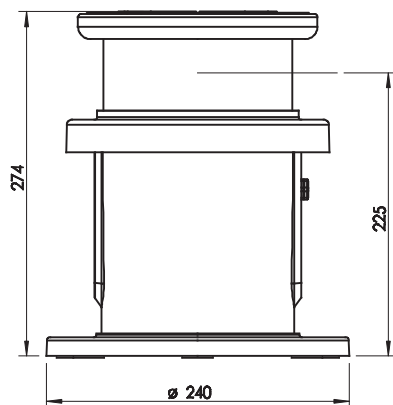

Optical System	
Light source:	Ultra-bright LED diode, with high-precision acrylic lens.
Luminous range:	Up to 4 nm (T=0.74) 5 nm (T=0.85).
Colours available:	White, green, red, amber and blue.
Vertical divergence:	Up to 15° (50% Io).
LED average life:	More than 100,000 hours.

Electronic control	
Flash rhythms:	256 (6 nos. user selectable).
Day/night threshold:	Adjustable in lux.
Solar charge regulation function:	Regulation in 3 phases.
Settings:	PC / IR programmer (optional Bluetooth).
Energy management:	Dynamic, according to latitude.
Light intensity reduction due to low battery:	Configurable by the user.

Solar module and battery	
Solar module:	1 no. of 2.5W.
Battery:	12 Ah, gelled, maintenance-free.
Autonomy without solar charging:	Up to 300 hours.

Materials and environment	
Base:	Glass-fibre reinforced polyamide PA66-GF30.
Lens cover:	Acrylic, UV stabilised.
Vibration resistance:	MIL-STD-202G, Method 204D (5G).
Shock resistance:	MIL-STD-202G, Method 213B.
Watertightness degree:	IP 68.
Fixings:	3 - 4 bolts in a 200mm diameter.
Humidity resistance:	100%. Pressure-compensation valve to avoid condensation.
Temperature range:	From -20° to 70°C.
Inside hardware:	Stainless steel.

Options
Infrared (IR) programmer.
PC programming kit.
Bluetooth programming.
Bird spikes.
Other specifications available under request.
MCL 140-SYNC (GPS synchronization).

MCL 140	PEAK INTENSITIES (Cd)
COLOUR	
White	50
Green	35
Red	25
Amber	56



**MEDITERRÁNEO SEÑALES MARÍTIMAS, S.L.L.**  
 mesemar@mesemar.com • www.mesemar.com

